

DIAGRAMS WITH THE JOINING DIMENSIONS – GMC 100, GMC 132 and GMCI 160 – B5 execution (with a flange)

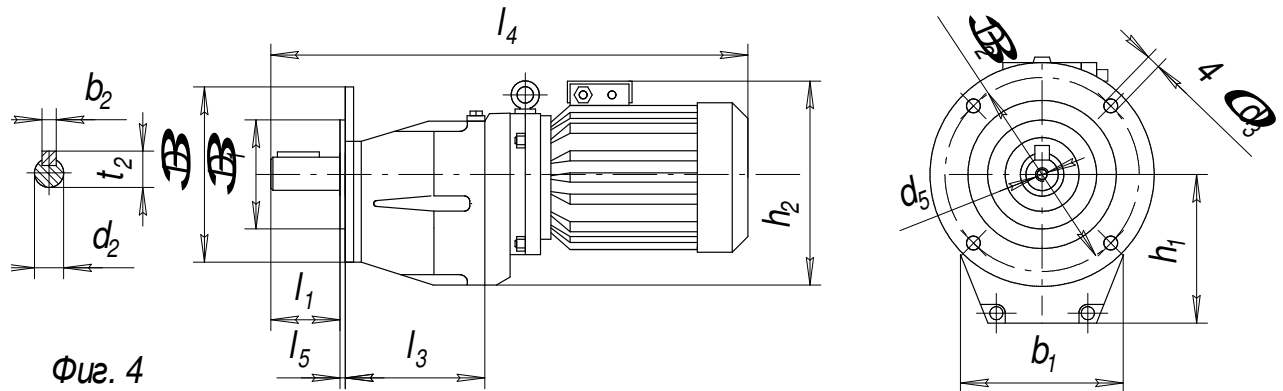

OVERALL AND JOINING DIMENSION OF GMC 100, GMC 132 and GMCI 160 (see the above diagram – B5 execution)

| Type of gear-motors (with a flange) | Type of motors | Означение (мм) | | | | | | | | | | | | | Table 2.4. | | |
|-------------------------------------|----------------|----------------|------------|-------|-------|-------|-------|-------|-------|-------|-------|-------|-------|----------|------------|--------------------|--|
| | | ϕd_2 | ϕd_3 | b_1 | b_2 | l_1 | l_3 | l_4 | l_5 | h_1 | h_2 | t_2 | d_5 | ϕD | ϕD_1 | $\phi D_2 \pm 0.1$ | |
| GMC 100 | MO 63 A-4D | 22 j 6 | 9 | 120 | 6 | 50 | 147 | 404 | 3.5 | 97 | 183 | 24.5 | M8 | 160 | 110 j 6 | 130 | |
| GMC 100 | MO 63 B-4D | 22 j 6 | 9 | 120 | 6 | 50 | 147 | 404 | 3.5 | 97 | 183 | 24.5 | M8 | 160 | 110 j 6 | 130 | |
| GMC 100 | MO 71 A-4D | 22 j 6 | 9 | 120 | 6 | 50 | 147 | 414 | 3.5 | 97 | 202 | 24.5 | M8 | 160 | 110 j 6 | 130 | |
| GMC 100 | MO 71 B-4D | 22 j 6 | 9 | 120 | 6 | 50 | 147 | 414 | 3.5 | 97 | 202 | 24.5 | M8 | 160 | 110 j 6 | 130 | |
| GMC 100 | T 80 A-4 | 22 j 6 | 9 | 120 | 6 | 50 | 147 | 471 | 3.5 | 97 | 206 | 24.5 | M8 | 160 | 110 j 6 | 130 | |
| GMC 100 | T 80 B-4 | 22 j 6 | 9 | 120 | 6 | 50 | 147 | 471 | 3.5 | 97 | 206 | 24.5 | M8 | 160 | 110 j 6 | 130 | |
| GMC 132 | MO 71 A-6D | 32 k 6 | 11 | 154 | 10 | 80 | 204 | 490 | 3.5 | 127 | 222 | 35.5 | M12 | 200 | 130 j 6 | 165 | |
| GMC 132 | MO 71 B-6D | 32 k 6 | 11 | 154 | 10 | 80 | 204 | 490 | 3.5 | 127 | 222 | 35.5 | M12 | 200 | 130 j 6 | 165 | |
| GMC 132 | MO 71 B-4D | 32 k 6 | 11 | 154 | 10 | 80 | 204 | 490 | 3.5 | 127 | 222 | 35.5 | M12 | 200 | 130 j 6 | 165 | |
| GMC 132 | MO 63 B-4D | 32 k 6 | 11 | 154 | 10 | 80 | 204 | 480 | 3.5 | 127 | 206 | 35.5 | M12 | 200 | 130 j 6 | 165 | |
| GMC 132 | T 80 A-6 | 32 k 6 | 11 | 154 | 10 | 80 | 204 | 537 | 3.5 | 127 | 229 | 35.5 | M12 | 200 | 130 j 6 | 165 | |
| GMC 132 | T 80 A-4 | 32 k 6 | 11 | 154 | 10 | 80 | 204 | 537 | 3.5 | 127 | 229 | 35.5 | M12 | 200 | 130 j 6 | 165 | |
| GMC 132 | T 80 B-4 | 32 k 6 | 11 | 154 | 10 | 80 | 204 | 537 | 3.5 | 127 | 229 | 35.5 | M12 | 200 | 130 j 6 | 165 | |
| GMC 132 | T 90 S-4 | 32 k 6 | 11 | 154 | 10 | 80 | 204 | 551 | 3.5 | 127 | 252 | 35.5 | M12 | 200 | 130 j 6 | 165 | |
| GMC 132 | T 90 L-4 | 32 k 6 | 11 | 154 | 10 | 80 | 204 | 591 | 3.5 | 127 | 252 | 35.5 | M12 | 200 | 130 j 6 | 165 | |
| GMC 132 | T 100 LA-4 | 32 k 6 | 11 | 154 | 10 | 80 | 204 | 612 | 3.5 | 127 | 260 | 35.5 | M12 | 200 | 130 j 6 | 165 | |
| GMC 132 | T 100 LB-4 | 32 k 6 | 11 | 154 | 10 | 80 | 204 | 612 | 4 | 127 | 260 | 35.5 | M12 | 200 | 130 j 6 | 165 | |
| GMCD 160 | T 80 B-6 | 48 k 6 | 14 | 193 | 14 | 110 | 242 | 612 | 4 | 156 | 256 | 51.5 | M16 | 250 | 180 j 6 | 215 | |
| GMCD 160 | T 90 S-6 | 48 k 6 | 14 | 193 | 14 | 110 | 242 | 636 | 4 | 156 | 279 | 51.5 | M16 | 250 | 180 j 6 | 215 | |
| GMCD 160 | T 80 B-4 | 48 k 6 | 14 | 193 | 14 | 110 | 242 | 612 | 4 | 156 | 256 | 51.5 | M16 | 250 | 180 j 6 | 215 | |
| GMCD 160 | T 90 S-4 | 48 k 6 | 14 | 193 | 14 | 110 | 242 | 636 | 4 | 156 | 279 | 51.5 | M16 | 250 | 180 j 6 | 215 | |
| GMCD 160 | T 90 L-4 | 48 k 6 | 14 | 193 | 14 | 110 | 242 | 676 | 4 | 156 | 279 | 51.5 | M16 | 250 | 180 j 6 | 215 | |
| GMCD 160 | T 100 LA-4 | 48 k 6 | 14 | 193 | 14 | 110 | 242 | 697 | 4 | 156 | 287 | 51.5 | M16 | 250 | 180 j 6 | 215 | |
| GMCD 160 | T 100 LB-4 | 48 k 6 | 14 | 193 | 14 | 110 | 242 | 697 | 4 | 156 | 287 | 51.5 | M16 | 250 | 180 j 6 | 215 | |
| GMCD 160 | T 112 M-4 | 48 k 6 | 14 | 193 | 14 | 110 | 242 | 697 | 4 | 156 | 297 | 51.5 | M16 | 250 | 180 j 6 | 215 | |